



## New Houses Provide Slow, Steady Growth for Schools

### Idea That Apartments Produce Crush of Students Is 'Myth'

New houses from residential redevelopment are fueling a "revitalization of Edina" that is helping stabilize Edina Public Schools' enrollment.

That may fly in the face of what many people think, but data analyzed by the state's premier demographer show people moving into those new homes are more likely to have school-age children than those in any other new housing in Edina.

"There is a relationship between school enrollment and housing, but it is a very complex relationship. And it is not the relationship that many people assume it to be," demographer Hazel Reinhardt said March 6 as she made a presentation to the Edina City Council and Edina School Board.

She pointed out that 88 percent of Edina Public Schools students live in single-family houses. The higher the market value of the house, the more likely it is to have school-age children. For example, houses valued at \$750,000 or more yield about 0.7 students per house. Those valued at less than \$300,000 yield just 0.23 students.

New houses have the most kids. Of the 191 houses built from Jan. 1, 2016, to June 30, 2018, they average 0.75 students per house.

Homes that sold during that time also brought students, at 0.62 per house. Houses that stayed under the same ownership produced about 1 child in Edina schools per every 2 houses, a much lower rate.

About 10 percent of public school students in Edina live in apartments, primarily in older units in the Parklawn Neighborhood, Reinhardt said. Hundreds of units in the City's newest apartment buildings have produced only a handful of schoolchildren, she added.

She called the concept of new apartments producing a crush of students "a myth," and not only in Edina.

"People get very excited about townhomes and apartments, and let me tell you that in every district we've ever worked in, it is single-family detached (houses) that yield school-age children," she said.

With women delaying having children and families having fewer children overall, many school districts are facing decreasing enrollment. That reduces funding, programs and affects the overall health of schools.

In Edina, the new houses and the families that come with those are helping drive a modest, manageable growth in school enrollment projections.

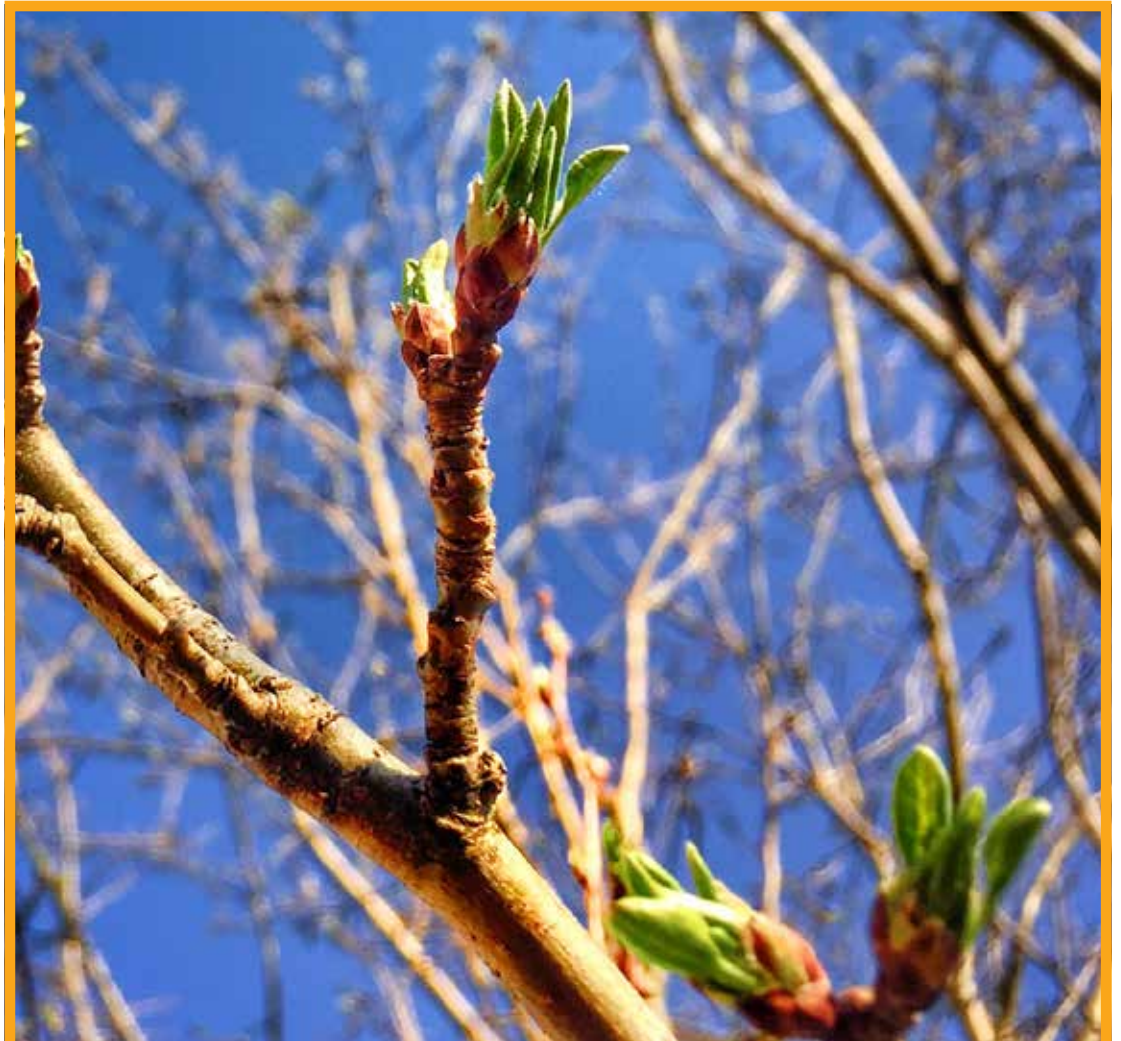

Photo by Anupama Puvvula

## 'Images of Edina' Photo Contest Starts

It's time to review your favorite photos from the last year! The City of Edina and *Edina Magazine* invite those who live, work or go to school in Edina to submit their best photos that tell Edina's story in the 16th-annual "Images of Edina" photo contest. Shown above is Anupama Puvvula's entry last year, "Every New Leaf Breaks the Winter Cold." For a complete list of official rules, contest criteria and to submit your photos, visit [EdinaMN.gov/PhotoContest](http://EdinaMN.gov/PhotoContest) or [edinamag.com](http://edinamag.com).

## Council Approves Citywide Organics Collection, Outside Refuse Storage

### Vierkant Disposal to Begin Weekly Organics Collection in 2020

For years, trash cans and recycling bins have mostly been relegated to dark corners of garages in Edina. Now, residents may store them outside.

Under an old local law, refuse containers were to be stored out of view from the street in front of the premises. At its March 19 meeting, the Edina City Council approved an ordinance amendment that allows residents to store containers within five feet of the dwelling unit or garage on the property.

The City Council also directed staff to negotiate a contract with Vierkant Disposal for weekly residential organics collection beginning in 2020. With another cart for organics, some residents could have up to four carts, so the change in law regarding their storage creates some flexibility.

A recent study by Hennepin County found that 25 percent of trash is made up of organic materials – the largest category within trash that could be diverted from landfills. In an effort to meet Minnesota Pollution Control Agency and Hennepin County waste reduction goals, the City of Edina issued a request for proposals for a residential curbside organics collection contract. Four companies responded.

The Council selected Vierkant for several reasons, including the company's existing organics customer base in Edina, pricing, location and commitment to customer service.

The Council is also weighing proposals for recycling collection and directed staff to get feedback from the community on collection frequency. A survey is under way. Residents can also weigh in at [www.BetterTogetherEdina.org](http://www.BetterTogetherEdina.org).

In other business last month, the Council:

- Established an Affordable Housing Fund. Buy-in funds that come to the City from housing developers had been placed into a restricted account with the intent that proceeds are to be used to further affordable housing opportunities. Creating the Trust Fund formalizes the practice.
- Approved guidelines for developers who propose projects within the Greater Southdale District. The Design Experience Guidelines are not a substitute for City zoning codes and ordinances, but instead provide substantial background for developers and design teams and a framework from which to approach proposed projects in the district. The guidelines also give the Planning Commission and City Council guidance for evaluating projects in the area.
- Approved a Memorandum of Understanding with Lime to provide bike and scooter sharing services in Edina in 2019.
- Approved an increase in utility franchise fees to provide additional funding for capital improvements for City property and equipment that further the City's overall conservation and sustainability goals. The franchise fee will increase 50 cents per month for Xcel Energy customers.
- Established the 72nd & France Tax-Increment Financing District to support the construction of affordable housing and public improvements at 7200 and 7250 France Ave.

The City Council will next meet April 16. For more information, visit [EdinaMN.gov](http://EdinaMN.gov).

### Where Do Students Live?

Edina School District  
Housing Type by Edina Public Schools Resident Student Yield

Housing Type	K-12 Students
Single-Family Detached	6,253
Apartments	599
Duplex Units, Split Duplex, Townhomes, Condominium Units	257

\*As of June 20, 2018

"To see the slow and steady growth generally is a good thing," said School Board member Sarah Patzloff.

She, Reinhardt and Mayor James Hovland all credited the excellent reputation of Edina Public Schools as one of the main reasons people move to Edina.

View the meeting where the presentation was made on the Edina TV channel on YouTube.



Edina's Residential Redevelopment Coordinator, Addison Lewis, began work March 18.

## City Hires New Residential Redevelopment Coordinator

### Customer Service is Priority for Lewis

The City of Edina's new Residential Redevelopment Coordinator, Addison Lewis, began on March 18, after working as the Planner/Economic Development Specialist for the City of Jordan.

"This is a unique position. I think Edina is the only city in the state that has a job like this. I was looking for something with planning, code enforcement and conflict resolution and this role checks off all of those items," said Lewis. "I view this as a customer service role, so my goal is to provide the best customer service to Edina residents that I can."

Lewis succeeds the City's first Residential Redevelopment Coordinator, Cindy Larson, who left the City earlier this year for a position in the private sector.

The role of Edina's Residential Redevelopment Coordinator is to ensure compliance with the City's ordinances and procedures, while also responding to questions and concerns from the public. The Residential Redevelopment Coordinator typically addresses issues stemming from construction of a new home such as parking, dust, noise, stormwater runoff and tree protection. The position does not mitigate architectural design issues.

"This City deals with complaints on residential construction for tear-downs and rebuilds, so Addison will be responsible for managing these concerns," said Chief Building Official David Fisher. "The role also is going to evolve into dealing with commercial properties as well when we have complaints about parking or noise issues, for example."

Lewis has spent his career working in the area of community development. In addition to his time in Jordan, he also worked for over five years with WSB & Associates, Inc., as a Community Planner. Before that, he held a Community Development & Planning internship with the City of Apple Valley. Lewis is currently working to earn a master's degree at Hamline University.

"I want to spend my career in local government and the Hamline Public Administration program really sets you up for leadership positions and management positions in local government, which will be a good fit for this role," said Lewis.

This role is unique, but Lewis brought a diverse skillset and experience that made him a great fit.

"Addison was a project manager for a street project on France Avenue when he worked at WSB. I thought he would be a good hire since he already understands customer service and is familiar with Edina," said Fisher.

For more information, contact Lewis at [AMLewis@EdinaMN.gov](mailto:AMLewis@EdinaMN.gov) or 952-833-9521.

## Southdale Library Location Decision Expected this Summer

### Two Locations Currently Being Explored

Hennepin County is exploring two possible locations for the new Southdale Library. These include rebuilding on the current site, 7001 York Ave. S., or building at Southdale Center.

HENNEPIN COUNTY  
LIBRARY



"Wherever the new library is, we are committed to continued excellence in library service, and will continue to service our community members and collaborate with them," said Janet Mills, Interim Library Director for Hennepin County. "With the modernization and refresh that comes with a new space, we'll take the opportunity to offer flexible seating responsive to the mobile technology that more people are bringing with them, improved spaces for quiet time and collaboration, and create a really welcoming space."

The County sent out an update in February saying public comments and priorities from past community meetings are a part of the discussion to decide which site to pursue. They are also considering the financial impacts, operating costs and access to other services, including public transportation.

They said "no matter the physical location, the new library will offer spaces for both focused and collaborative work, technology to bridge the digital divide, a variety of seating options with access to power sources, ample library materials and early learning spaces for school readiness."

With a decision reached this summer, the new library should open by 2022.

For more information, visit [www.hclib.org/southdale](http://www.hclib.org/southdale). To receive future updates via email, contact [SouthdaleProject@hclib.org](mailto:SouthdaleProject@hclib.org) to add your email to the list.

## Upcoming Events

### Recurring Events:

Children's Entertainment at Edinborough Park

**Noon Thursdays**

Family Night at Braemar Field

**6:30-7:30 p.m. Saturdays through April 27**

**Friday, April 5, 6:30 p.m.**

Family Movie Night, "Christopher Robin," Edinborough Park

**Saturday, April 6, 10 a.m.-noon**

Town Hall meeting, Braemar Golf Course

**Tuesday, April 9, 6-8:30 p.m.**

Creating Your Resilient Yard Workshop, Public Works & Park Maintenance Facility

**Wednesday, April 10, 2-4 p.m.**

Energy Efficiency Benchmarking Meeting for Business Owners and Managers, Edina City Hall

**Thursday, April 11, 6-7:30 p.m.**

Installing Turf Alternatives Workshop, Public Works & Park Maintenance Facility

**Thursday, April 11, 7:30 a.m.**

Housing & Redevelopment Authority Meeting, Edina City Hall

**Saturday, April 13, 10 a.m.**

The Author's Studio: Seize your Life: How to Carpe Diem Every Day with Jasmine Stringer, Edina Art Center

**Monday, April 15, 5:30 p.m.**

Community Volunteer Recognition Reception, Braemar Golf Course

**Wednesday, April 16, 7 p.m.**

City Council Meeting, Edina City Hall

**Friday, April 19, 7-8:30 p.m.**

Edina's First Refugees: The Irish at Cahill Settlement, Minnehaha Grange Hall

**Saturday, April 20, 9 a.m.**

Walk With the Mayor, 50th & France, Edina Landmark Theater

**Tuesday, April 23, 4:30-6 p.m.**

Edina Master Water Stewards Coffee Klatch, Edina City Hall

**Thursday, April 25, 7:30 a.m.**

Housing & Redevelopment Authority Meeting, Edina City Hall

**Thursday, April 25, 5 p.m.**

Opening Reception: Minnesota Artists Association, Edina Art Center

For a complete listing of meetings and events, visit [EdinaMN.gov](http://EdinaMN.gov).

### BY THE NUMBERS

## France Avenue Bridge Construction

The Minnesota Department of Transportation is improving the France Avenue bridge over Minnesota Highway 62. As a part of the project, drivers will notice improved pavement, a new traffic signal, accessible sidewalks and a lengthened ramp to eastbound Highway 62. Construction is expected to be complete in mid-July.

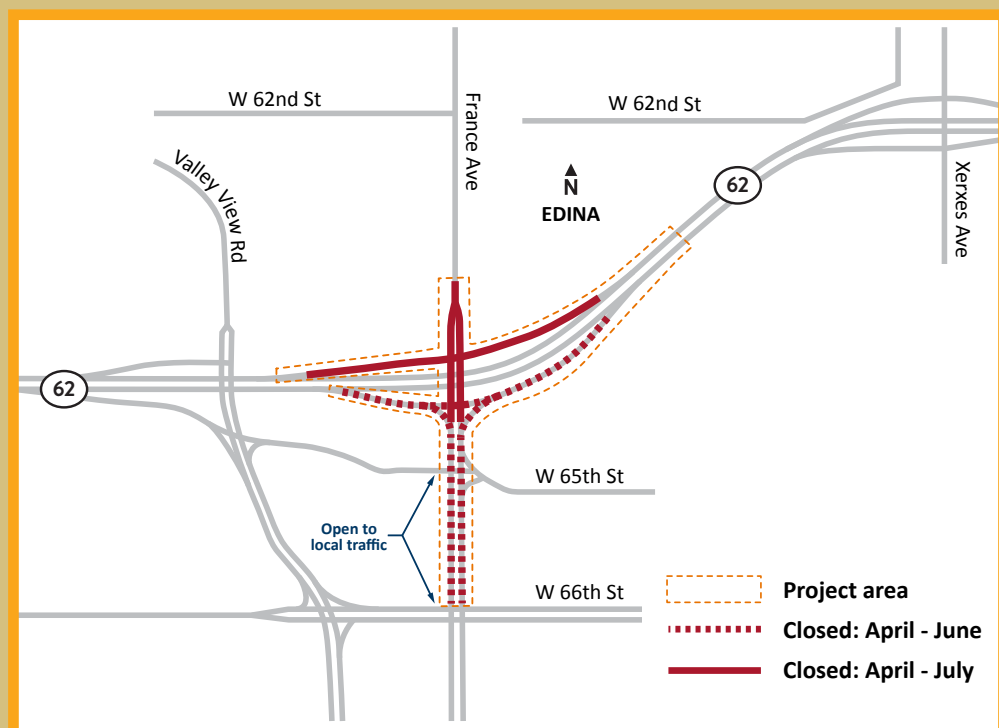

**2**

detours:

To northbound France Avenue from Highway 62: Xerxes Avenue to 60th Street

To southbound France Avenue from Highway 62: Valley View Road to France Avenue

The project will cost approximately

Approximately **\$4.3** Million



**5** Benefits:

- New bridge deck
- Improved traffic flow
- Improved access to Highway 62
- Improved accessibility for pedestrians
- Smoother ride

